

Model CML Series

Compression

Miniature High Capacity Load Cell (5t~15t)

- High capacity & Compact size

- 17-4PH Stainless steel

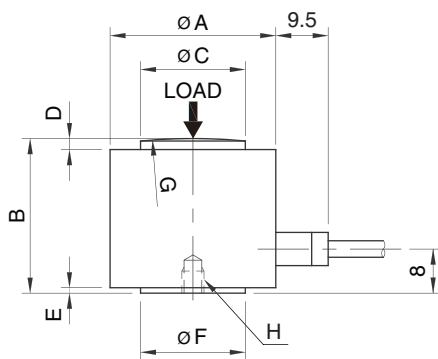
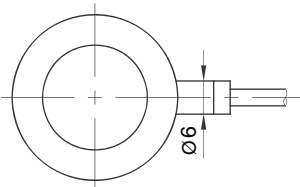

SPECIFICATIONS

MODEL	CML
Rated capacity (R.C.)	5, 10, 15ton
Rated output(R.O.)	2mV/V (Normal)
Non-linearity	$\leq 0.5\%$ R.O.
Hysteresis	$\leq 0.5\%$ R.O.
Non-repeatability	$\leq 0.2\%$ R.O.
Creep error	$\leq 0.1\%$ in 20min.
Zero balance	$\leq 1\%$ R.O.
Compensated temperature range	-10 ~ 70°C
Operating temperature range	-20 ~ 80°C
Temp. effect on rated output	$\leq 0.01\%$ LOAD/°C
Temp. effect on zero balance	$\leq 0.01\%$ R.O./°C
Terminal input resistance	410 Ohms \pm 30 Ohms
Terminal output resistance	350 Ohms \pm 5 Ohms
Insulation resistance (Min.)	2000 MOhms at 50V DC
Excitation voltage	3~12V(Recommended), 15V(Max.)
Electrical connection	$\phi 3\text{mm} \times 1.5\text{m}$ (28AWG x 4Core Shielded)
Protection class	meets IP 65
Safe overload	150% R.C
Ultimate overload	300% R.C
Material	Stainless steel (17-4PH)

ORDERING INFORMATION

CML - 10T
 MODEL CAPACITY
 CML 5, 10, 15t

WIRING INFORMATION

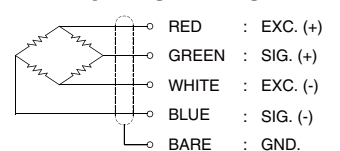

Dimension-mm

Capacity	ϕA	B	ϕC	D	E	ϕF	G	H	Weight (kg)
5t (49.04kN)	24	22	14	2	1	14	R70	M4 x 0.7P Depth 3	0.10
10t (98.07kN)	30	28	19	2	1	19	R100	M4 x 0.7P Depth 3	0.14
15t (147.1kN)	34	32	23	2	1	23	R100	M4 x 0.7P Depth 4	0.20

* Specifications are subject to change without notice

JUL, 2022