

Model OBBH Series

Bending Beam Load Cell (10kg ~ 500kg)

The OBBH series single ended bending beam load cell is designed for tension or compression loading applications including bench scale and conveyor weighing.



- 17-4PH stainless steel construction for high accuracy and corrosion resistance.

- Fully welded seal with stainless steel bellows for hostile environments and washdown applications.

SPECIFICATIONS

MODEL	OBBH
Rated capacity (R.C.)	10, 20, 50, 100, 200, 500kg
Rated output (R.O.)	2mV/V ± 0.3%
Non-linearity	≤ 0.03% R.O.
Hysteresis	≤ 0.02% R.O.
Non-repeatability	≤ 0.02% R.O.
Creep error	≤ 0.03% in 20min.
Zero balance	≤ 1% R.O.
Compensated temperature range	-10 ~ 70°C
Operating temperature range	-20 ~ 80°C
Temp. effect on rated output	≤ 0.02% LOAD/10°C
Temp. effect on zero balance	≤ 0.02% R.O./10°C
Terminal input resistance	400 Ohms ±20 Ohms
Terminal output resistance	350 Ohms ±5 Ohms
Insulation resistance (Min.)	2000 MOhms at 50V DC
Excitation Voltage	10V(Recommended) /15V(Maximum)
Electrical connection	∅5mmx3m(22AWG x 4Core Shielded)
Protection class	meets IP 67
Safe overload	150% R.C
Ultimate overload	300% R.C

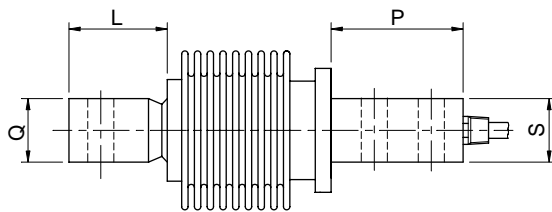
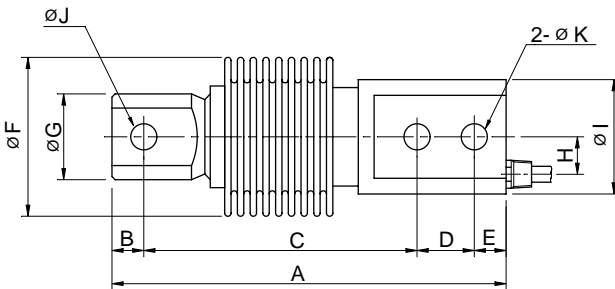

ORDERING INFORMATION

OBBH - 50

MODEL CAPACITY
10, 20, 50, 100kg,
200, 500kg

WIRING INFORMATION

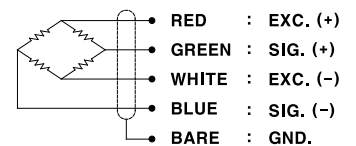

Dimension-mm

Rated Capacity	A	B	C	D	E	F	G	H	I	J	K	L	P	Q	S	Weight(kg)
10~100kg(98.07N~980.7N)	120	10	82	18	10	38	23	10	32	8.5	8.5	21	41	20	20	0.9
200~500kg(1.96kN~4.90kN)	210	22	133	40	15	50	29	14	52	12	14	44	75	25	40	1.9

* Specifications are subject to change without notice

DEC, 2005